



100



500

Photos May Show Some Available Options

---

## ELMDOR/STONEMAN TRISOLATOR PIPING ISOLATOR

**Sound Transmission Control** - Trisolator isolates the piping from its support, thus preventing, at the source, the transmission of sound.

**Vibration Control** - Trisolator absorbs vibrations and prevents vibration noise between the hanger and piping.

**Electrolysis Control** - Trisolator prevents electrolytic action at the point of support.

**Piping Protection** - Trisolator cushions the piping and prevents the support from scratching the surface and crushing or deforming the piping.

Expansion, contraction and the flow of fluids and gasses through piping create extremely objectionable sounds and vibrations which are transmitted to the building structure through piping supports. The use of copper tubing with dissimilar metal such as cast iron pipe hangers may cause electrolytic action resulting in the ultimate replacing of the piping. Glass piping requires protection to prevent surface scratching. Plastic piping requires protection to prevent deforming or damage through crushing. Trisolator provides an efficient solution to these problems.

**Trisolator is engineered to do the job.** Heavy gauge die-formed metal shell and specially processed hair felt are engineered to support the weight of the piping and its contents. Felt is coated with a non-conducting binder to resist the effects of moisture, abrasion and temperature and is chemically treated to repel vermin.

### Recommended Specifications

Furnish and install Stoneman Trisolator at each pipe hanger and pipe support on both hot and cold-water piping. Use No. 100 for SPS pipe and No. 500 for copper tubing.



Member of U.S. Green  
Building Council

**TRISOLATOR**

Revised: 08/31/18

Recyclable  
Product

**Series 100 for SPS Pipe**

NOMINAL PIPE SIZE	DIMENSIONS SHOWN IN DRAWINGS BELOW			PIPE HANGER SIZE
	A	B	C	
1/2"	2"	1-1/4"	1-5/32"	3/4"
3/4"	2"	1-1/4"	1-5/16"	1"
1"	2"	1-1/4"	1-21/32"	1-1/4"
1-1/4"	2"	1-1/4"	1-29/32"	1-1/2"
1-1/2"	2"	1-1/4"	2-3/8"	2"
2"	2"	1-1/4"	2-7/8"	2-1/2"
2-1/2"	2-1/2"	1-1/4"	3-1/2"	3"
3"	2-1/2"	1-1/4"	4"	3-1/2"
3-1/2"	3-1/4"	1-1/4"	4-1/2"	4"
4"	3-5/8"	1-3/8"	5-9/16"	5"
5"	4"	2"	6-5/8"	6"
6"	4-1/2"	2"	8-5/8"	8"

**Series 500 for Copper Tubing**

NOMINAL PIPE SIZE	DIMENSIONS SHOWN IN DRAWINGS BELOW			PIPE HANGER SIZE
	A	B	C	
1/2"	2"	1-1/4"	1-5/32"	3/4"
3/4"	2"	1-1/4"	1-5/32"	3/4"
1"	2"	1-1/4"	1-5/16"	1"
1-1/4"	2"	1-1/4"	1-21/32"	1-1/4"
1-1/2"	2"	1-1/4"	1-29/32"	1-1/2"
2"	2"	1-1/4"	2-3/8"	2"
2-1/2"	2"	1-1/4"	2-7/8"	2-1/2"
3"	2-1/2"	1-1/4"	3-1/2"	3"
3-1/2"	2-1/2"	1-1/4"	4"	3-1/2"
4"	3-1/4"	1-1/4"	4-1/2"	4"
5"	3-5/8"	1-3/8"	5-9/16"	5"
6"	4"	2"	6-5/8"	6"

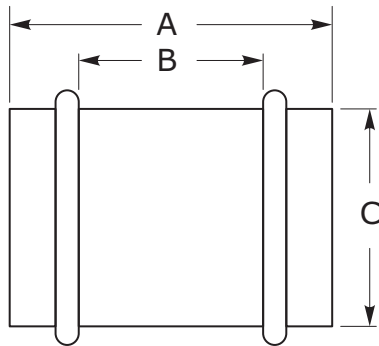

1/2" to 3" IPS  
1/2" to 3-1/2" NCT

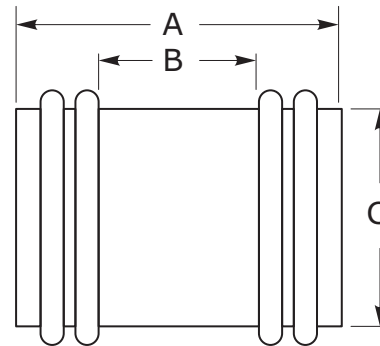

3-1/2" to 6" IPS  
4" to 6" NCT

**Regularly Furnished**

- 1) Type as determined by figure number selected.
- 2) Shells are made from die formed heavy gage galvanized steel.
- 3) Isolating Pads are specially processed non-conducting hair felt.

**WARNING:** Cancer and Reproductive Harm - [www.P65Warnings.ca.gov](http://www.P65Warnings.ca.gov)

Dimensions are subject to manufacturer's tolerance of plus or minus 1/4". Elmdor/Stoneman assumes no responsibility for use of void or suspended data. Please visit [www.elmdorstoneman.com](http://www.elmdorstoneman.com) for most current specifications. © Copyright 2009 Elmdor/Stoneman, City of Industry, CA, A Division of Acorn Engineering Company.

**SELECTION SUMMARY & APPROVAL FOR MANUFACTURING**

Model Number & Options _____	Quantity _____
Company _____	Date _____
Contact _____	Title _____
Approval for Manufacturing/Signature _____	

**100/500**

Revised: 08/31/18